

**特点 Features:**

- 触点容量: 40A触点切换能力  
Contact switching capability:40A.
- PCB 端子  
PCB terminals
- 高防震, 防冲击能力  
Highly shockproof and anti-impact performance

**触点参数 CONTACT DATA**

型号	Model	YQ502
触点形式	Contact Arrangement	1A、1B、1C
接触电阻	Contact Resistance	50mΩ Max.
触点材料	Contact Material	银合金 Silver Alloy
额定负载(阻性)	Contact Rating ( Res.Load )	40A 14VDC
最大切换电流	Max. Switching Current	40A
最大切换电压	Max. Switching Voltage	30VDC
最大切换功率	Max. Switching Power	560W
机械寿命	Mechanical endurance	1x10 <sup>7</sup> 次 OPS
电气寿命	Electrical endurance	1x10 <sup>5</sup> 次 OPS

**性能参数 CHARACTERISTICS**

吸合时间(额定电压下)	Operate Time ( at nomi.volt. )	6ms Max.
释放时间(不带二极管)	Release Time ( without diode )	3ms Max.
绝缘电阻	Insulation Resistance	100MΩ Min.( 500VDC )
介质耐压	Dielectric Strength	触点与触点间 Between Open Contacts : 500VAC, 50/60Hz 1 min.
		触点与线圈间 Between Coil & Contacts: 500VAC, 50/60Hz 1 min.
抗振性	Vibration resistance	误动作 Functional: 10~55Hz 双振幅 1.5mm ( DA )
		耐久 Destructive: 10~55Hz 双振幅 1.5mm ( DA )
抗冲击	Shock resistance	误动作 Functional: 10G Min.
		耐久 Destructive: 100G Min.
环境温度	Ambient Temperature	-40℃~+125℃ (不冷凝 No condensation)
重量	Unit Weight	约 Approx. 20.0g

**线圈参数 COIL DATA (at 23℃)**

额定电压 Rated voltage (VDC)	额定电流 Rated current ±10%(mA)	线圈电阻 Coil resistance ±10%(Ω)	最大连续外加电压 Max allowable voltage VDC (Max.)	吸合电压 Operate voltage VDC (Max.)	释放电压 Release voltage VDC (Min.)	额定功率 Rated coil power (W)
12	133.3	90	额定电压的 of rated voltage 150 %	额定电压的 of rated voltage 70 %	额定电压的 of rated voltage 10 %	约 approx. 1.6
24	66.7	360				

## 订货标记示例 ORDERING INFORMATION

YQ502	-S	-1	12	D	M	U	2	
							轭铁脚形式 Yoke Terminal Arrangement :	无-3个轭铁脚, 2-两个轭铁脚 Nil-3 yoke terminals, 2-2 yoke terminals
							端子形式 Terminal Arrangement :	U-美国脚位, E-欧洲脚位 U-USA footprint, E-Europe footprint
							触点形式 Contact form :	无-转换, M-常开, B-常闭; Nil-Form C, M-Form A, B-Form B
							线圈功耗 Coil power :	D-1.6 W
							线圈规格 Coil voltage :	12,24 (VDC)
							触点组数 Number of poles :	1-1组 1-1 Group
							封装形式 Protective construction :	S-塑封式 S-Flux proofed
							基本型号 Type designation :	YQ502

## 外形尺寸、接线图、安装孔位图 (单位: mm)

## OUTLINE DIMENSIONS, WIRING DIAGRAM AND PCB LAYOUT (Unit: mm)

外形尺寸  
Outline Dimensions

塑封型  
Plastic Sealed type

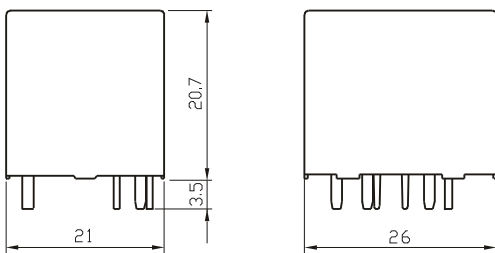

敞开型  
Open type

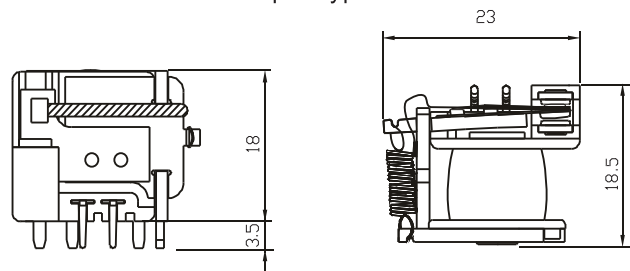

安装孔位图 (底视图)  
PCB Layout (Bottom View)

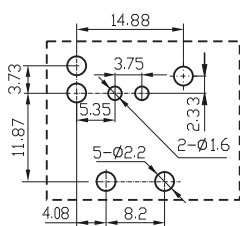

美国脚位(U)  
USA footprint (U)

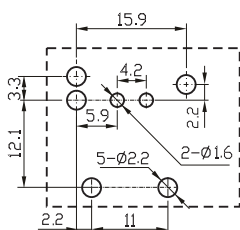

欧洲脚位(E)  
Europe footprint (E)

接线图 (底视图)  
Wiring Diagram (Bottom View)

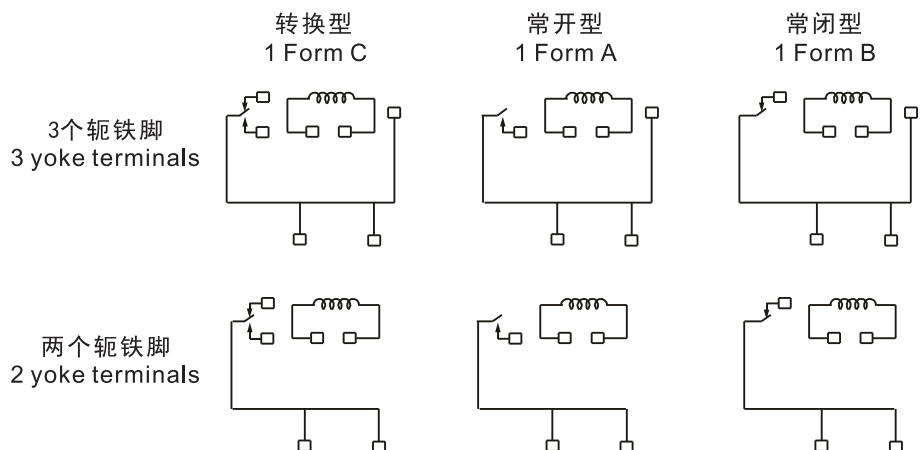

注 Remark :

1. 未标注尺寸公差 Unmarked dimensional tolerance  
≤1mm: ±0.2mm ; (1~5)mm: ±0.3mm ; ≥5mm: ±0.4mm.
2. 安装孔尺寸公差: ±0.1mm.  
The tolerance of PCB layout is always: ±0.1mm.
3. 引出脚尺寸为预焊前尺寸。  
Extended terminal dimension is dimension before soldering.

## 性能曲线图 CHARACTERISTIC CURVES

环境温度与线圈电压关系图  
Ambient temperature vs. coil voltage

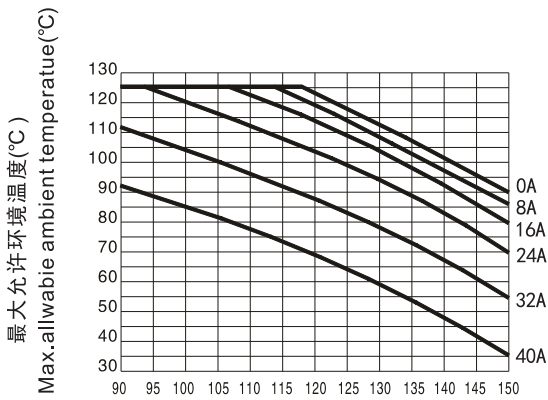

线圈电压额定值百分比  
% of Nominal Coil Voltage

释放时间/吸合时间  
Operate time/Release time

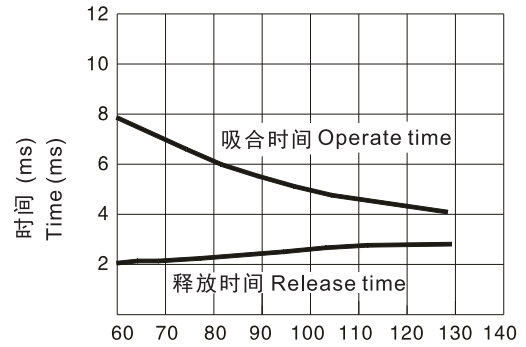

线圈电压额定值百分比  
% of Nominal Coil Voltage

寿命曲线  
Endurance Curve

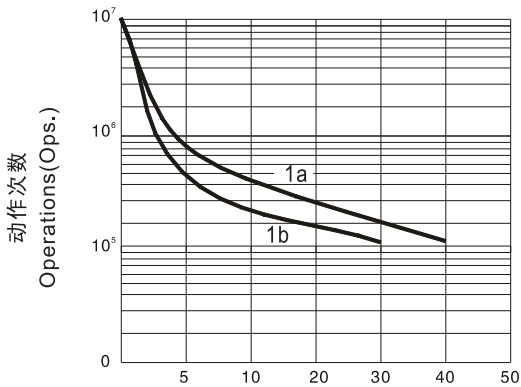

触点电流(A)  
Contact Current(A)

阻性负载下常开触点的灭弧能力  
Anti-arc capability of N.O. Contacts with Res. Load

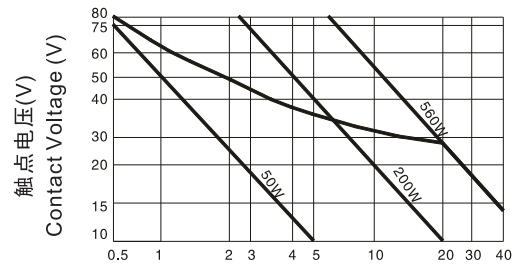

触点电流(A)  
Contact Current(A)