

# Tact Switch

## YST-1101S SMD Type



### Feature

Reflow solderable type of YST-1101.  
Available operating forces : 180gf, 250gf

### Applications

For various operation in digitalized devices.  
For potable audio, mobile phones, personal digital assistants and notebook PCs.

### Specifications

Item	Rating	Travel	Contact Resistance	Bounce	Operating Force	Operating Life
Value	DC 12V 50mA MAX	0.25 ± 0.1mm	100mΩ MAX	10m sec MAX	180 ± 50gf	50,000 Cycle

### Dimensions

#### Height (L)

TAG	(Blank)	A			
Value (mm)	4.3	5.0			

#### Width (P)

	(Default)	by order	by order		
Value (mm)	9.0	10.0	8.0		

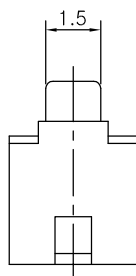
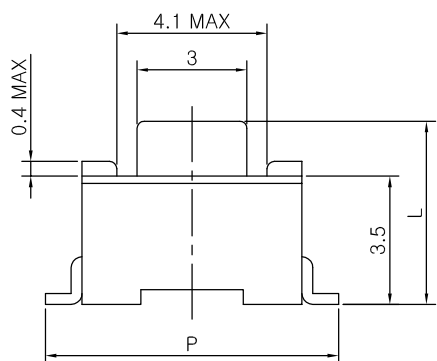
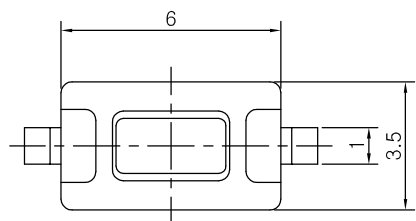

#### CIRCUIT DIAGRAM

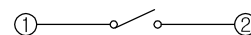

#### PCB MOUNTING HOLE DIMENSIONS

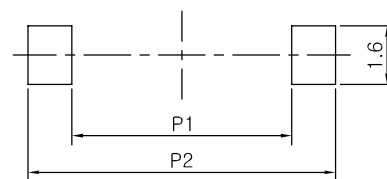

P (mm)	P1 (mm)	P2 (mm)
8.0	6.0	9.2
9.0	6.4	10.2
10.0	6.4	11.2

# REEL POCKET

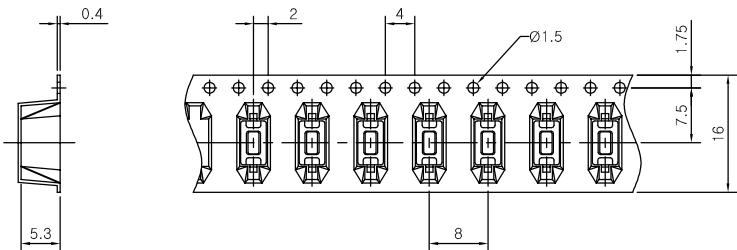

- 1. General Tolerance : 0.1mm
- 2. Angle for pocket side : 5°
- 3. Pocket Material : Plastic
- 4. Packing quantity : 1,500 PCS
- 5. Reel Diameter : 330mm