

# Tact Switch

## YST-1158U SMD Type



### Feature

6.2mm x 6.5mm demenssion with anti-ESD ground.  
Reflow solderable.

Available operating forces : 160gf, 250gf

### Applications

Audio devices, office equipment, communication devices, TV set, video devices. etc.

### Specifications

Item	Rating	Travel	Contact Resistance	Bounce	Operating Force	Operating Life
Value	DC 12V 50mA MAX	0.25 ± 0.1mm	100mΩ MAX	10m sec MAX	160 ± 50gf	80,000 Cycle

### Dimensions

#### CIRCUIT DIAGRAM

#### PCB MOUNTING HOLE DIMENSIONS

# REEL POCKET

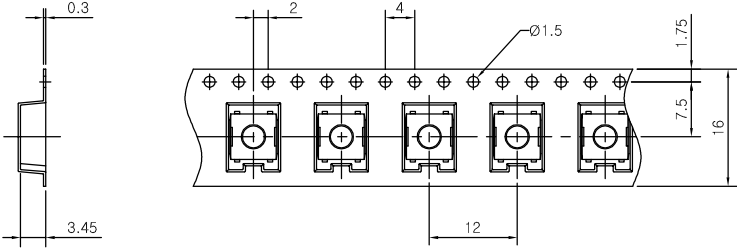

- 1. General Tolerance : 0.1mm
- 2. Angle for pocket side : 5°
- 3. Pocket Material : Plastic
- 4. Packing quantity : 1,500 PCS
- 5. Reel Diameter : 330mm